



# ADMIN & SAFETY

SAFETY DOESN'T HAPPEN BY ACCIDENT



## QUICK TOUCH POINTS

- SAFETY CHARTS
- FIRE SAFETY
- INTRUDER ALERT
- PANIC ALARM (WHY AND WHEN)
- MEDICAL SAFETY
- RFID & SAFETRAX
- ALEXA

**We stay prepared for a day that should never come**



# SAFETY CHARTS

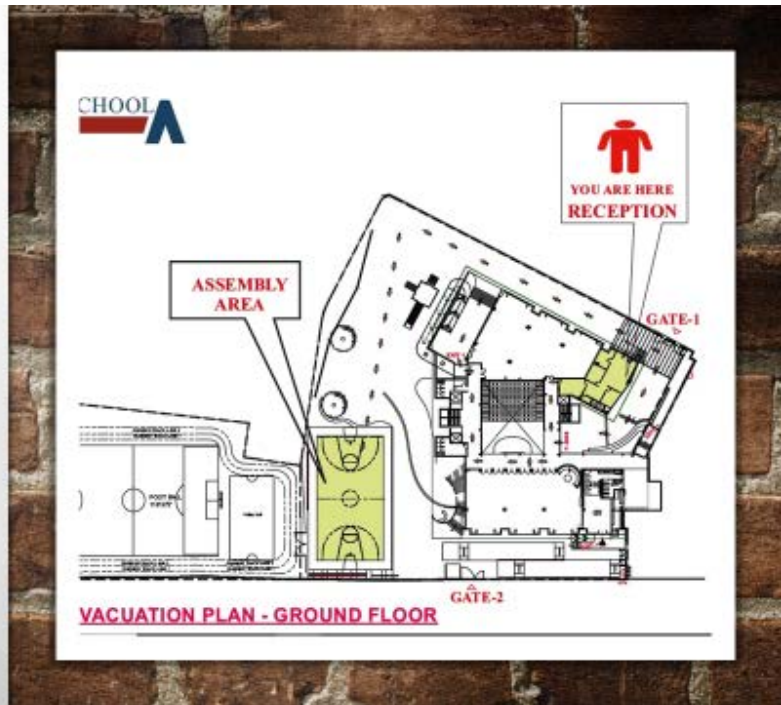

## FIRE SAFETY

- EVACUATION PROTOCOL
- ALL FLOORS HAVE TWO EXIT POINTS
- STAY ALERT FOR PA SYSTEM MESSAGES
- HELP WILL ARRIVE



Smoke Detectors

Fire Alarm Buttons



**Importance of school attendance**

# INTRUDER ALERT



Noticed on Camera

Security Breach



Alert Staff



- **INTRUDER – IF & WHEN UNKNOWN THREATS ENTER PREMISES...**
- **MUSIC WILL START PLAYING ON THE PA SYSTEM VIA ALEXA**
- **HIDE & TAKE COVER PROTOCOL TO BE FOLLOWED**
- **HELP WILL ARRIVE TO ASSIST EVACUATION IF REQUIRED**

# PANIC ALARM



- **STUDENT / TEACHER IN DISTRESS**
- **REACH OUT FOR PANIC ALARM**
- **WAIT FOR ASSISTANCE**



# MEDICAL EMERGENCY



- PANIC ALARM PROTOCOL
- INFORM RECEPTION
- HELP FROM INFIRMARY
- WE HAVE A TIE-UP WITH HOSPITAL FOR PRIORITY CARE (HOLY FAMILY)

**Importance of medical information**



# RFID & SAFETRAX

- KNOW YOUR ATTENDANCE
- GOOD TO KNOW PEOPLE WHO CARE, KNOW WHERE YOU ARE. 📍
- WEAR YOUR ID CARDS
- ENSURE YOUR STUDENTS WEAR THEM TOO...
- GOOD TO KNOW SOMEONE RESPONSIBLE IS WATCHING OUT FOR YOU



**Importance of using our technology**

# ALEXA



**Reminders for study periods**

**Alerts & Alarms**

**Music**

**World Study**

**Information**

